

.965-14NGO-LH-INT

STANDARD® CYLINDER VALVE OUTLET CONNECTION FOR
PRESSURES UP TO 3000 psig (20 680 kPa) FOR
Sulfur Hexafluoride

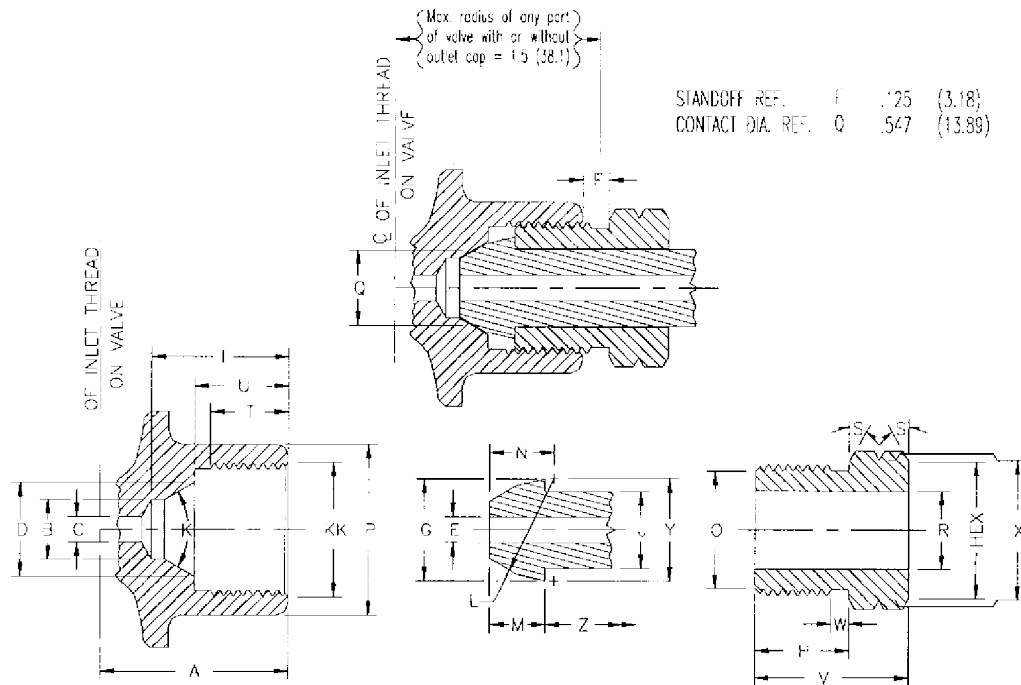

VALVE OUTLET

THREAD	.965-14NGO-LH-INT	
MINOR DIA.	.8877-.8954	(22.548-22.743)
PITCH DIA.	.9186-.9222	(23.333-23.423)
MAJOR DIA.	.9650 Min.	(24.511) Min.
LENGTH	A 1.375 Max.	(34.93) Max.
C'BORE DIA.	B .437 Max.	(11.10) Max.
DRILL DIA.	C .187 ±.060	(4.75 ±1.52)
SEAL DIA.	D .687 ±.015	(17.45 ±0.38)
C'BORE DEPTH	I 1.00 Min.	(25.4) Min.
ANGLE	K 60°	
BOSS DIA.	P 1.25 Min.	(31.8) Min.
FULL THREAD	T .562 Min.	(14.27) Min.
BORE DEPTH	U .687 ±.015	(17.45 ±0.38)
C'SINK DIA.	KK 90° x .984	(24.99)

NIPPLE ②

DRILL DIA.	E .187 ±.060	(4.75 ±1.52)
NOSE DIA.	G .745	(18.92)
SHANK DIA.	J .562-.557	(14.27-14.15)
NOSE RADIUS	L .750	(19.05)
NOSE LENGTH	M .406 ±.015	(10.31 ±0.38)
CENTER LINE	N .469 ±.015	(11.91 ±0.38)
RADIUS L CENTERS	Y .750	(19.05)
SHANK LENGTH	Z 1.12 Min.	(28.4) Min.

All dimensions are in inches (millimeters).

HEXAGON NUT

THREAD	.965-14NGO-LH-INT	
MAJOR DIA.	.9600-.9550	(24.384-24.257)
PITCH DIA.	.9136-.9100	(23.205-23.114)
MINOR DIA.	.8724 Max.	(22.158) Max.
HEX	1 or 1-1/8	(25.4 or 28.6)
SHANK LENGTH	H .687 ±.015	(17.45 ±0.38)
CHAMFER DIA.	O 45° x .859	(21.82)
HOLE DIA.	R .567-.572	(14.40-14.53)
CHAMFER DIA.	S 30° x 1.00	(25.4)
	or	
	30° x 1.125	(28.58)
LENGTH	V 1.125 Min.	(28.58) Min.
UNDERCUT DIA.	W .16 ±.03 x .86	(4.1 ±0.8 x 21.8)
GROOVE DIA.	X 60° x 1.02	(25.9)
	or	
	60° x 1.14	(29.0)

Limited Standard® for air (R729) (not for breathing) and Nitrogen

① Also used for gas mixtures: see CGA V-7.

② Nipple may be made from 11/16 (17.5) hex material.

③ For non-USP or NF applications.